

# HORIZONTAL RAILING SIDE SUPPORT

## BASE SUPPORT

### BASIC INFO

**Number of Connections:**

One

**Number of Set Screws:**

Two

**Finishes Available:**

Galvanized

**Piece Allow Movement:**

No

The Horizontal Rail Support is an end fitting made to hold a pipe in place without letting it run through the fitting and is fashioned to secure to a horizontal surface. The fitting has a lip created to keep the pipe from running through the fitting. The base has two screw holes for to secure the fitting to the base and two screws are included for securing the pipe to the fitting.

**FEATURES:**

- Hot-dipped galvanized coating for corrosion resistance
- Iron construction for durable performance
- Easy installation and removal, no permanent connections
- No special tools needed
- Use an Allen Wrench for connections
- Able to operate in temperatures ranging from -20°C to 300°C

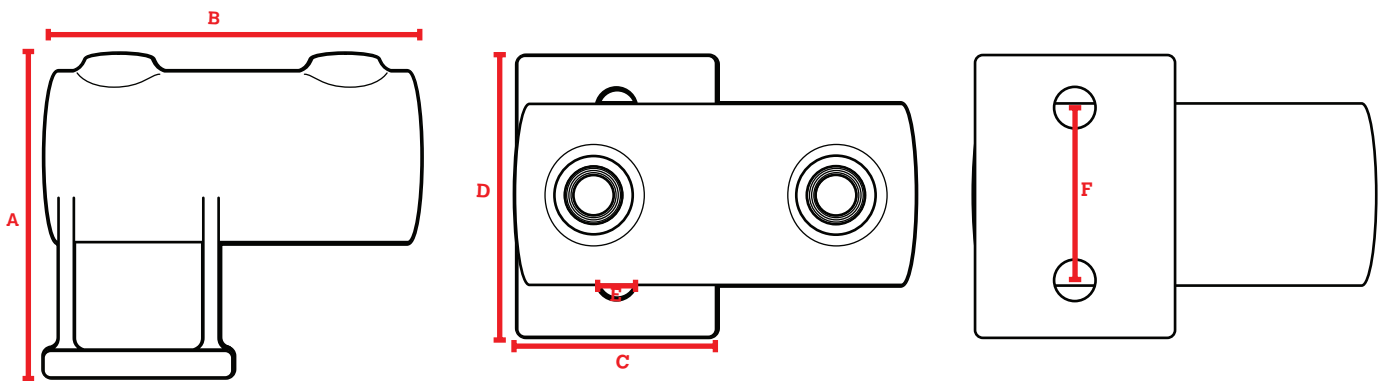

Part #	Finish	Sizing	Set Screw (in x mm)	A (Total Height)	B (Total Width)	C (Base Width)	D (Base Length)	E (Screw Hole Diameter)	F (Screw Hole Distance)	Fits Pipe OD (in)	Weight (lbs)
674-506HC	Galvanized	1-1/4in	3/8 x 12.7	3.75	4.38	2.09	4.33	0.57	2.83	1.660	2.57