

DOUBLE TAB OFFSET FLANGE

SHELF/WALL SUPPORT

BASIC INFO

Number of Connections:

One

Number of Set Screws:

One

Finishes Available:

Black & Galvanized

Piece Allow Movement:

No

Double Tab Offset Flanges let you secure a surface to your pipe projects. This flange slides over a pipe with flat tabs allowing for a solid surface, like wood, to be placed over the pipe and the tabs have two pre-drilled holes to secure the fitting to the surface. The single screw is included with this fitting.

FEATURES:

- Hot-dipped galvanized or black electrophoretic coating for corrosion resistance
- Iron construction for durable performance
- Easy installation and removal, no permanent connections
- No special tools needed
- Use an Allen Wrench for connections
- Able to operate in temperatures ranging from -20°C to 300°C

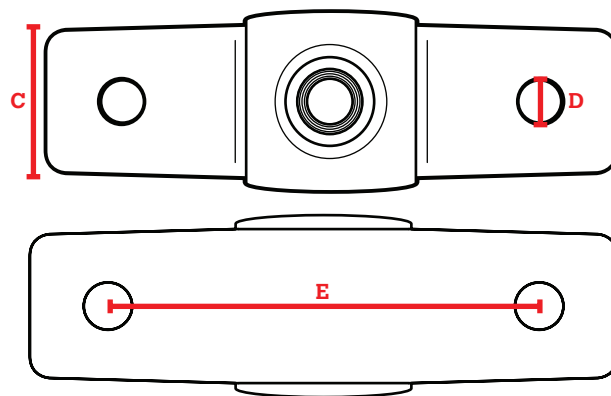
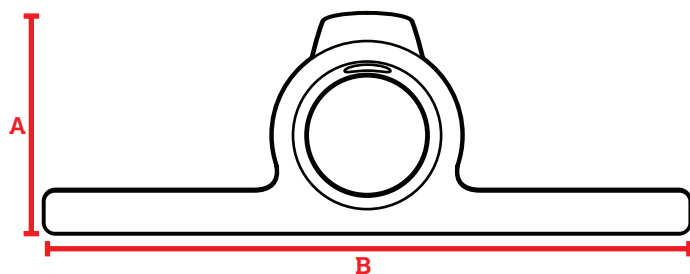

Part #	Finish	Sizing	Set Screw (in x mm)	A (Total Height)	B (Total Width)	C (Plate Length)	D (Plate Width)	E (Screw Hole Diameter)	Fits Pipe OD (in)	Weight (lbs)
679-802HC	Galvanized	3/8in	1/8 x 10	1.26	2.59	0.75	0.32	1.81	0.68	0.16
679-804HC	Galvanized	3/4in	1/4 x 12.5	1.69	5.04	1.38	0.39	2.63	1.050	0.67
679-806HC	Galvanized	1-1/4in	3/8 x 12.7	2.33	5.12	1.30	0.39	3.87	1.660	0.81
689-802HC	Black	3/8in	1/8 x 10	1.26	2.59	0.75	0.32	1.81	0.68	0.16
689-804HC	Black	3/4in	1/4 x 12.5	1.69	5.04	1.38	0.39	2.63	1.050	0.67