

## DOUBLE SWIVEL SOCKET



**676-704HC** | 3/4in  
**676-706HC** | 1-1/4in

### DESCRIPTION:

Double Swivel Sockets are unique in that this fitting lets you adjust two pipes to a custom angle with a central running pipe. The central pipe runs through the central fitting point and the two end pipe fittings have swivel connections to let you adjust the angle of the pipe. Each connection point on the fitting comes with a screw.

### FEATURES:

- Hot-Dipped Galvanized coating for corrosion resistance
- Iron construction for durable performance
- Easy installation and removal, no permanent connections
- No special tools needed
- Use an Allen Wrench for connections
- Able to operate in temperatures ranging from -20°C to 300°C

### DIMENSIONAL DATA:

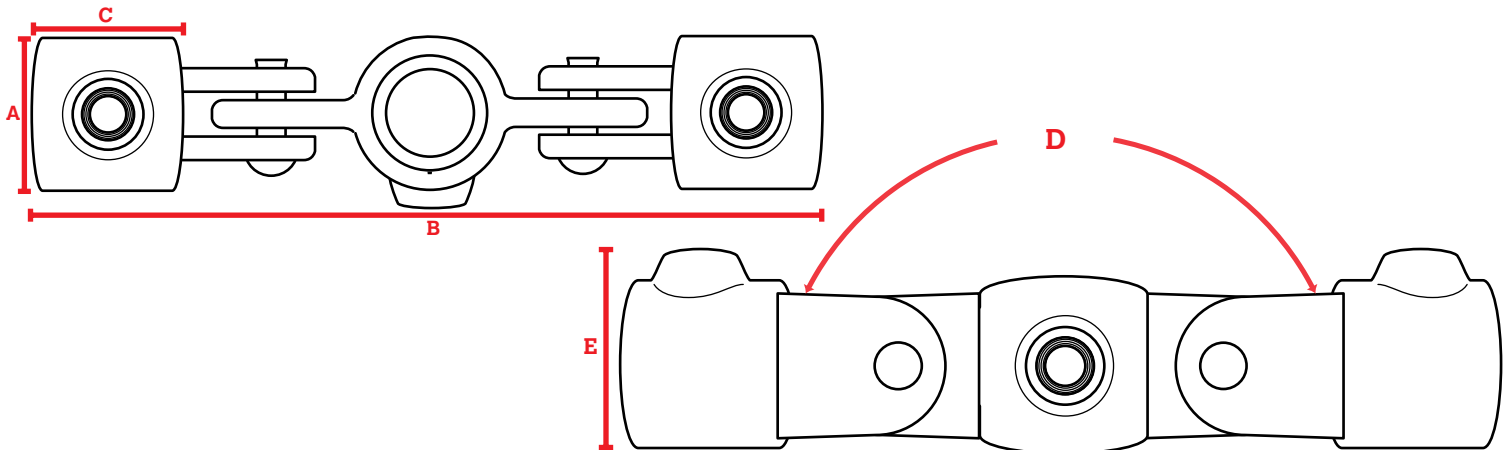

PART #	SIZING	INSTALLATION SCREW (IN X MM)	A (Total Height)	B (Total Width)	C (Insert Depth)	D (Angle)	E (Depth)	FITS PIPE OD (IN)	WEIGHT (LBS)
676-704HC	3/4in	1/4 x 12.5	1.46	7.96	1.18	180°	1.67	1.050	1.47
676-706HC	1-1/4in	3/8 x 12.7	2.17	9.17	1.50	160°	2.33	1.660	2.88

### CERTIFICATIONS & SAFETY:

- Materials meets ASTM A-197 Standard
- Not for Plumbing Applications
- Not for Scaffolding Applications
- Made to fit with SteelTek Pipe

#### California Prop 65 Warning:

This product contains chemicals including lead known to the State of California to cause cancer and birth defects or other reproductive harm. Wash hands after use.